

Track Slides

Track Slide Measurements

Bainbridge International's track slides have been carefully designed to allow compatibility with the widest possible range of mast sections. Design and material selection leads to trouble-free use and maximum strength even under the most arduous conditions. High strength metal slides are also available for each type of track to be used in the more highly stressed head and clew positions.

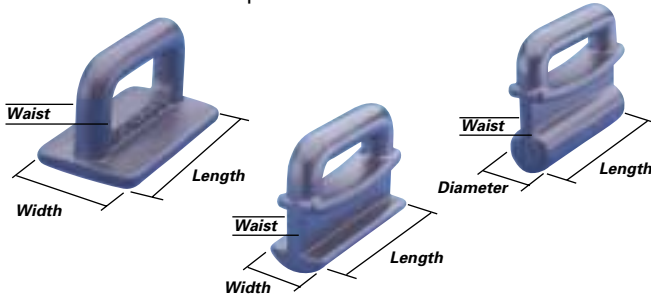

Internal Flat Slides - Plastic

▲ Injection moulded in nylon 66.



Part No.	Width: mm/in	Waist: mm/in	Length: mm/in	Pack Qty
A007	15.8 %	6.8 ¼	30.0 1 ½	100
A008	19.0 %	9.0 ¾	33.0 1 ½	100
A009	22.2 %	11.0 ⅞	35.0 1 ½	100

Internal Flat Slides - Stainless Steel

▲ Cast Stainless Steel, electro-polished.
▲ Low friction PTFE coating.



Part No.	Width: mm/in	Waist: mm/in	Length: mm/in	Pack Qty
B307	16.0 %	7.0 ¼	40.0 1 ½	10
B308	20.0 %	7.0 ¼	40.0 1 ½	10
B309	22.0 %	7.0 ¼	40.0 1 ½	10

Proctor Mast Slides

▲ Cast stainless steel encapsulated in low friction injection moulded nylon.



Part No.	Width: mm/in	Waist: mm/in	Length: mm/in	Pack Qty
B009	24.0 ⅝	11.0 ⅞	50.0 2	10
B010	30.0 1 ⅞	16.0 %	50.0 2	10

Holt Allen Slides - Plastic

▲ Alternate style to A009 slide.



Part No.	Width: mm/in	Waist: mm/in	Length: mm/in	Pack Qty
A0091	22.0 %	11.0 ⅞	39.0 1 ⅞	100

Metal Mast Slides - Plastic

▲ Designed for use in the Metal Mast system.



Part No.	Width: mm/in	Waist: mm/in	Size Reference	Pack Qty
A006M	20.0 %	10.0 ¾	6	100
A008M	24.0 ⅝	11 ⅞	8	100

Bronze Flat Internal Track Slides

▲ Designed for use in the Metal Mast system.
▲ Used at the headboard, clew outhaul or around/near luff reef rings.



Part No.	Width: mm/in	Waist: mm/in	Size Reference	Pack Qty
B006	20.0 %	10.0 ¾	6	100
B008	24.0 ⅝	11 ⅞	8	100

Allslip Internal Low Friction Slides

▲ Manufactured from low friction nylon plastic alloy.
▲ Overall length of 45mm gives good bearing surface.
▲ Positive location in mast groove for free running in compression and tension.
▲ A114 is specially designed for use in Selden Mast Sections fitted with flush gates.

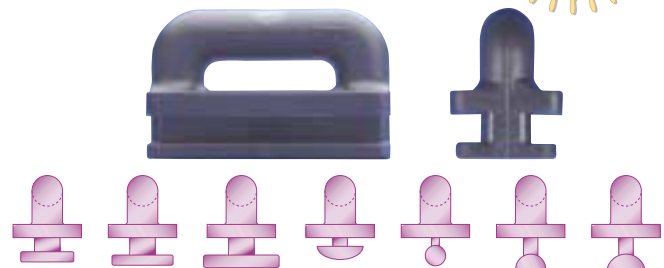

Part No.	Width: mm/in	Waist: mm/in	Length: mm/in	Pack Qty
A107	15.8 %	7.0 ¼	45.0 1 ¾	10
A108	19.0 %	9.0 ¾	45.0 1 ¾	10
A109	22.2 %	11.0 ⅞	45.0 1 ¾	10
A114	15.6 %	4.4 ⅞	45.0 1 ¾	10
A116	8.0 ⅝	4.0 ½	45.0 1 ¾	10
A117	9.3 %	4.0 ½	45.0 1 ¾	10
A118	12.5 ½	4.0 ½	45.0 1 ¾	10

Track Slides



Sailman 3500 Slides

Sailman 3500 slides are ideal for use as head and luff slides in composite spars or masts with very narrow grooves. The slides are moulded from the latest high strength, low friction plastics so there are no metal parts that could wear composite sections or damage anodising.

The U00377 has an ultra thin 3.4mm waist that makes these one of the few high strength slides that is suitable for sections originally designed for bolt ropes. They are also ideal for wing masts.

The three flat versions are ideally suited as full batten slides for spars with sail feeding gates that stand proud of the aft face of the mast.

- ▲ All plastic construction to eliminate wear on anodising and composite sections.
- ▲ High strength and low friction for efficient operation.
- ▲ Easy web on attachment to sail.



Part No.	Width: mm/in	Waist: mm/in	Length: mm/in
U00361	15.5 5/8	7.3 1/2	55 2 1/8
U00363	17.9 7/8	8.7 1 1/8	55 2 1/8
U00365	21.5 7/8	10.3 3/8	55 2 3/8
U00377	8.8 1/2	3.4 1/8	55 2 3/8

Sailman 3500 & 4000 Heavy Duty Double Linked Slides

Sailman double slides are an ideal solution for high load areas of the sail such as headboards and clews. Sailman 3500 versions are particularly useful for head assemblies on composite spars where stainless slides could damage the track.



U02365

Part No.	Description	Width: mm/in	Waist: mm/in	Length: mm/in
U02361	Linked Double Slide 15.5mm	15.5 5/8	7.3 1/2	115 4 5/8
U02363	Linked Double Slide 18mm	17.9 7/8	8.7 3/8	115 4 5/8
U02365	Linked Double Slide 22mm	21.5 7/8	10.3 3/8	115 4 5/8
U02377	Linked Double Slide 9.0mm Diameter	9.0 3/8	3.4 1/8	115 4 5/8

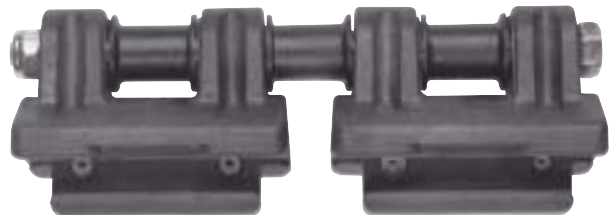

U02464

Part No.	Description	Width: mm/in	Length: mm/in
U02462	Linked Double Slide 16mm Flat	16.3 5/8	115 4 5/8
U02464	Linked Double Slide 19mm Flat	18.8 3/4	115 4 5/8
U02466	Linked Double Slide 23mm Flat	23 7/8	115 4 5/8
U02468	Linked Double Slide 24mm Flat	24 15/16	115 4 5/8
U02472	Linked Double Slide 10mm Slug	10 3/8	115 4 5/8
U02474	Linked Double Slide 11mm Slug	11 7/8	115 4 5/8

Sailman 3500 & 4000 Heavy Duty Triple Linked Slides

Triple linked slides provide even greater strength and can be made up using 3 intermediate slides (see sailman section for details) and the linking rod shown below. Used for head and high load applications.

- ▲ Triple linking rod is supplied with additional cotton reels used as spacers between slides.
- ▲ To use order 3 intermediate slides and drill through the threaded holes of two of the slides. Insert U00667 Triple Linking Rod through both drilled slides and spacers. Finally, screw the remaining slide onto the linking rod and secure with lock nut.



Part No.	Description	Length: mm/in
U00667	Triple Linking Rod	215 8 5/8

Track Slides

Internal Slug Slides - Plastic

▲ Injection moulded in nylon 66.



Part No.	Diameter: mm/in	Waist: mm/in	Length: mm/in	Pack Qty
A016	7.9 5/16	3.0 1/8	27.0 1 1/8	100
A017	9.3 3/8	3.0 1/8	27.0 1 1/8	100
A018	12.5 1/2	3.0 1/8	27.0 1 1/8	100

Slug Slides with Welded Stainless Steel Bail

▲ Moulded-in welded bail gives maximum strength.



Part No.	Diameter: mm/in	Waist: mm/in	Length: mm/in	Pack Qty
A016S	6.9 5/16	2.5 1/8	27.0 1 1/8	100
A017S	8.1 5/16	2.5 1/8	27.0 1 1/8	100
A019S	10.0 3/8	3.4 1/8	30.0 1 1/8	100
A018S	11.0 7/16	3.4 1/8	30.0 1 1/8	100

Internal Slug Slides - Stainless Steel

▲ Cast Stainless Steel, electro-polished.

▲ Low friction PTFE coating.



Part No.	Diameter: mm/in	Waist: mm/in	Length: mm/in	Pack Qty
B035	8.0 5/16	3.5 1/8	37.0 1 1/8	10
B036	8.6 5/16	3.5 1/8	37.0 1 1/8	10
B037	11.0 7/16	3.5 1/8	37.0 1 1/8	10

Heavy Duty Slug Slides with Moulded-in Bail

▲ Injection moulded in low-friction nylon, with captive stainless steel bail.

▲ Also used for mainsail tack to give close-in attachment of sail to mast.



A031

Part No.	Diameter: mm/in	Waist: mm/in	Length: mm/in	Pack Qty
A031	8.0 5/16	3.0 1/8	50.0 2	10
A032	9.3 3/8	3.0 1/8	50.0 2	10
A033	12.5 1/2	4.0 1/8	75.0 3	10

Internal Slug Slides - Cast Alloy

▲ Diecast in aluminium alloy and coated with teflon.



B102

Part No.	Diameter: mm/in	Waist: mm/in	Length: mm/in	Pack Qty
B101	12.0 1/2	2.5 1/8	38.0 1 1/2	10
B102	12.0 1/2	4.0 1/8	72.0 2 1/2	10

Heavy Duty Slug Slides - Stainless Steel

▲ Diecast in stainless steel, electro-polished.

▲ Low friction PTFE coating.



Part No.	Diameter: mm/in	Waist: mm/in	Length: mm/in	Pack Qty
B011	8.0 5/16	3.0 1/8	60.0 2 3/8	10
B012	10.0 3/8	3.0 1/8	60.0 2 3/8	10
B013	12.5 1/2	3.0 1/8	60.0 2 3/8	10

Selden Mast Slides - Plastic

▲ A015 is especially designed for use on boats over 40 feet.



Part No.	Width: mm/in	Waist: mm/in	Length: mm/in	Pack Qty
A013	11.0 7/16	3.0 1/8	22.0 7/8	100
A014	14.0 9/16	4.0 1/8	30.0 1 1/8	100
A015	15.0 1/2	4.0 1/8	40.0 1 5/8	10

Selden Mast Slides - Stainless Steel

▲ Cast Stainless Steel, electro-polished.

▲ Low friction PTFE coating.



Part No.	Width: mm/in	Waist: mm/in	Length: mm/in	Pack Qty
B044	14.0 9/16	4.0 1/8	37.0 1 1/8	10